

KERN

SINCE 1974

KERN

SINCE 1974

MANUFACTURER FOR EXCLUSIVE TIMEPIECES

HARMONY

Tizian

GRAND DAME

VISION

La Princesse

LA FEMME

Les Briolettes

FALCON LINE

CONTENT

History	2
Philosophy	3
Guilloché	5
Harmony	8
Tizian	28
Grand Dame	44
Vision	48
La Princesse	72
La Femme	78
Les Briolettes	90
Falcon Line	94

A few words - by August L. Kern

Besides the ability to manufacture sportive chronometers (and also complicated jewel watches set with precious stones) the company KERN shows an almost inexhaustible creativity developing new product lines in which the tradition and elegance are always taken into account.

For more than thirty-five years perfection and exclusiveness are our company`s basis and their significance will remain in future to match our sophisticated customers` and to meet the expectations put upon us. Correctness, flexibility and innovation are capitalized with us and will guarantee the international success of the brand of KERN further on.

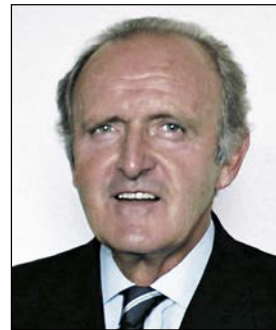

Committed to tradition

The watch manufacturing company KERN was founded on 1st October 1974 by the master engraver and designer August L. Kern and has been led under his management since then. The qualified education and ideals of the founder are substantially responsible for the development of the product lines and the company success of KERN. In order to ensure the future of the brand and to remain the business in family property his son, Stefan Kern, entered the group in the year 2000 and is responsible for sales and marketing ever since.

For more than thirty-five years jewellery and timepieces of highest quality have been manufactured at KERN and marketed internationally under this name. Specially selected

precious stones and diamonds as well as Swiss movements and components of highest quality are exclusively used for our products. In connection with innovative design these elements give our products unmistakable character and significance.

Since the foundation of our company the product assortment has been developed continuously and new models have been added considering newest arts of manufacturing to be able to present a high-quality program with more than 650 watch variations to our specific circle of customers. In order to extend the already available collections of 18kt gold watches, the production of exclusive stainless steel watches with precious stones and diamonds was started in 1995 and driven forward ever since.

It's not all about innovation

Perfection, exclusiveness and individuality are at first place at KERN and are the basis for all our products. Starting from conception and further development up to presentation specific procedures for the backup of the quality and reliability are used in order to guarantee these basic principles. The harmonious connection of most modern technologies, best Swiss manufactured movements as well as innovations with traditional basic ideas and manual skill is of course a matter at KERN.

The passion of the employees for the watchmaker's art and the love of detail which both are not to be replaced by supporting technologies and machines is the most important good of a watch manufactory.



Another constituent of our philosophy contains the long-standing cooperation's with leading Swiss suppliers and partners who also contribute to the high quality standard of our products. You, our customer, are in the center of all our efforts. Due to our flexibility it is possible to adapt existing models to individual customer's wishes to obtain a personalized product.

In order to take both your and our own high claims into account, we attach great importance to the careful selection of our worldwide representatives. The watch collection of KERN with its various limited editions and special models therefore is distributed exclusively by certified dealers so that experienced customer advisory and on-site services are ensured.

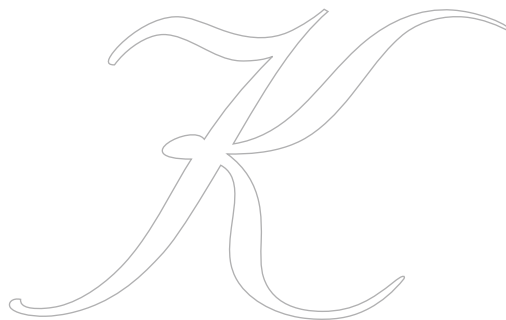

The art of dial guilloché

Guilloché is a very old and traditional craft which was developed by the Frenchman Guillot more than two centuries ago and is practiced only by few specialists in this unchanged way until today. With this precious art (there are similarities to engraving) regular patterns and ornaments from straight and curved lines are made by hand onto metal surfaces with special tools.

Due to the filigree work and fineness of the faces to be worked on long-standing experience and high dexterity are necessary to elaborate elegance perfectly.

The conception of a guilloché dial requires sound knowledge about this adornment technique so that the result has all desired visual attributes.

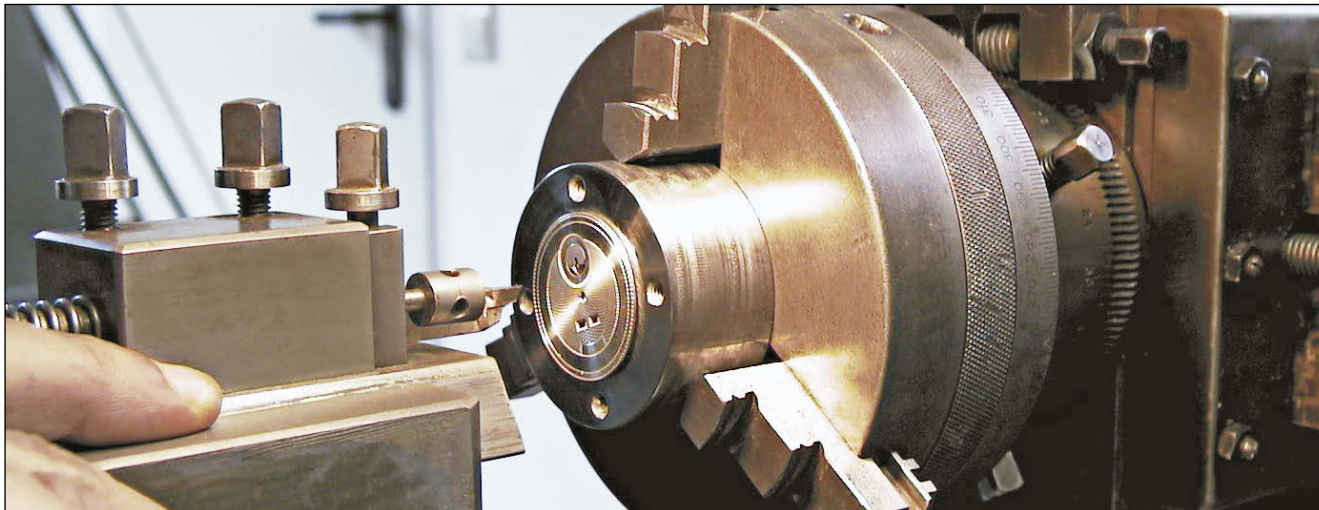

At KERN technical details are designed with support of CAD- and 3D- procedures and their realizability is checked repeatedly. Executed with great care the guilloche work starts with the manual setting-up and positioning of the silver dial on the lathe. To complete a sophisticated and effortful dial more than two

hundred single operations are needed which require a long time to be correctly executed. A perfect unicum which underlines the individuality of the future owner of the watch stands at the end of the demanding work of the Guillocheur.

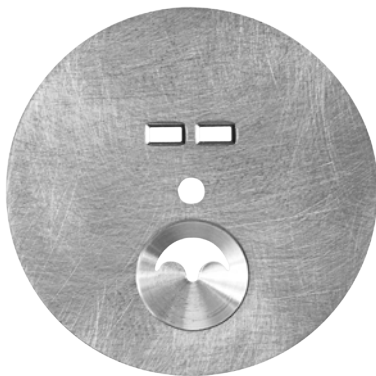

basic sterling silver dial

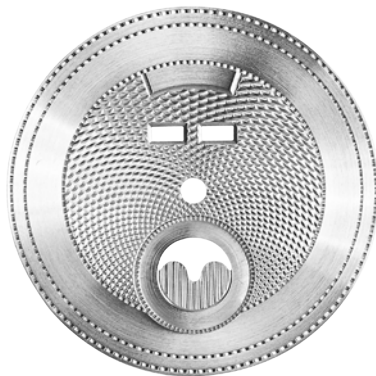

dial after hand guilloché on rose engine

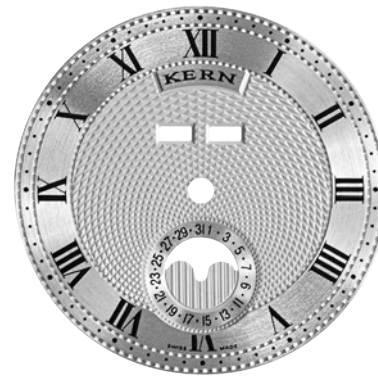

final dial with prints

In celebration of our 30th anniversary KERN presented the special collection “Jubilee”. Each watch model of this collection is decorated in an exclusive and elaborate way of watchmaking, to point out traditional watchmaking skills. By Hand guilloche dial on rose engine, flame-blued hands and screws, circular-graining, satin finishing, hand sewn alligator leather straps, diamond setting by hand, skeleton automatic movement with hand engraved ornaments are delighting hallmarks of quality and therefore carried on.



Jubilee

KERN

COLLECTION - SERIES

HARMONY



Ref. 65 11-2528-WQDB

Harmony - 1

18kt white gold watchcase set with 46 diamond tapers princess cut (4.64ct) and 30 diamonds (2.17ct), cut sapphire crystal, water resistant (3 ATM), high quality Swiss quartz movement, mother-of-pearl dial set with 139 diamonds (0.52ct), black numerals in Roman style, black hands, satin strap with 18kt gold lock set with 40 diamonds (0.42ct).

Limited Edition: 25 pieces





Ref. 6511-2528-WQDB

Harmony - 1

18kt white gold watchcase set with 46 diamond tapers princess cut (4.64ct) and 30 diamonds (2.17ct), cut sapphire crystal, water resistant (3 ATM), high quality Swiss quartz movement, mother-of-pearl dial set with 139 diamonds (0.54ct), black numerals in Roman style, black hands, natural silk strap with ornamental stitching and 18kt gold pin buckle set with 40 diamonds (0.42ct).

Limited Edition: 25 pieces



Ref. 6511-2530-WQDB

Harmony - 2

18kt white gold watchcase and multipart gold bracelet set with 484 diamonds (8.61ct), cut sapphire crystal, water resistant (3 ATM), high quality Swiss quartz movement, mother-of-pearl dial set with 137 diamonds (0.52ct), black numerals in Roman style, black hands, bracelet with screw-system for length adjustment, safety snap buckle.

Limited Edition: 25 pieces





Ref. 65 11-2530-GQDB

Harmony - 2

18kt yellow gold watchcase and multipart gold bracelet set with 484 diamonds (8.61ct), cut sapphire crystal, water resistant (3 ATM), high quality Swiss quartz movement, mother-of-pearl dial set with 137 diamonds (0.52ct), black numerals in Roman style, black hands, bracelet with screw-system for length adjustment, safety snap buckle.

Limited Edition: 25 pieces



Ref. 6511-2531-GQDB

Harmony - 3

18kt yellow gold watchcase and multipart gold bracelet set with 574 diamonds (7.48ct), cut sapphire crystal, water resistant (3 ATM), high quality Swiss quartz movement, mother-of-pearl dial set with 139 diamonds (0.54ct), black numerals in Roman style, black hands, bracelet with screw-system for length adjustment, safety snap buckle.

Limited Edition: 25 pieces



Ref. 65 11-2531-WQDB

Harmony - 3

18kt white gold watchcase and multipart gold bracelet set with 574 diamonds (7.48ct), cut sapphire crystal, water resistant (3 ATM), high quality Swiss quartz movement, mother-of-pearl dial set with 139 diamonds (0.54ct), black numerals in Roman style, black hands, bracelet with screw-system for length adjustment, safety snap buckle.

Limited Edition: 25 pieces



Driven by creativity and perfectionism we spent several months with all motivation in our development for a new model. During this period, different test phases and prototypes are manufactured to present finally perfect quality timepieces. Our technical environment with modern 3D systems and machines can only support the traditional craftsman but it will never replace them.

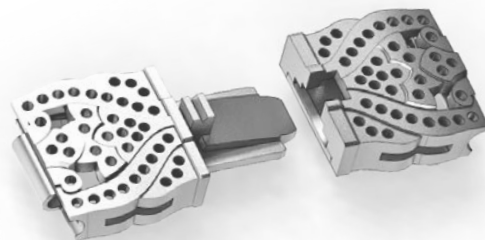
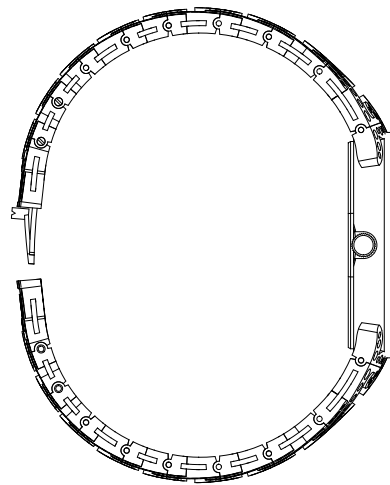



Ref. 65 11-2533-GQDB

Harmony - 2.1

18kt yellow gold watchcase and multipart gold bracelet set with 654 diamonds (3.54ct), cut sapphire crystal, water resistant (3 ATM), high quality Swiss quartz movement, mother-of-pearl dial set with 137 diamonds (0.52ct), black numerals in Roman style, black hands, bracelet with screw-system for length adjustment, safety snap buckle.

Limited Edition: 25 pieces



Ref. 6511-2535-WQDB

Harmony - 4

18kt white gold watchcase and links set with 679 diamonds (5.75ct) and 26 diamond squares princess cut (1.46ct), cut sapphire crystal, water resistant (3 ATM), high quality

Swiss quartz movement, mother-of-pearl dial set with 137 diamonds (0.52ct), black numerals in Roman style, black hands, alligator leather strap and 18kt gold pin buckle set with 73 diamonds (0.43ct).

Limited Edition: 25 pieces





Ref. 65 11-2535-WQDB a

Harmony - 4

18kt white gold watchcase and links set with 679 diamonds (6.14ct) and 26 diamond squares princess cut (1.46ct), cut sapphire crystal, water resistant (3 ATM), high quality Swiss quartz movement, mother-of-pearl dial (Tahiti) set with 137 diamonds (0.52ct), silver numerals in Roman style, black hands, alligator leather strap and 18kt gold pin buckle set with 73 diamonds (0.43ct).

Limited Edition: 25 pieces



Ref. 6511-2536-GQDB

Harmony - 5

18kt yellow gold watchcase and multipart gold bracelet set with 1621 diamonds (12.22ct), cut sapphire crystal, water resistant (3 ATM), high quality Swiss quartz movement, mother-of-pearl dial set with 139 diamonds (0.54ct), black numerals in Roman style, black hands, bracelet with screw-system for length adjustment, special safety snap buckle.

Limited Edition: 25 pieces





Ref. 65 11-2536-WQDB

Harmony - 5

18kt white gold watchcase and multipart gold bracelet set with 1621 diamonds (12.22ct), cut sapphire crystal, water resistant (3 ATM), high quality Swiss quartz movement, mother-of-pearl dial set with 139 diamonds (0.54ct), black numerals in Roman style, black hands, bracelet with screw-system for length adjustment, special safety snap buckle.

Limited Edition: 25 pieces



Ref. 6511-2537-WQDB

Harmony - 6
18kt white gold watchcase and links set with
1085 diamonds (8.02ct) and 63 diamond
squares princess cut (5.67ct), cut sapphire
crystal, water resistant (3 ATM), high quality
Swiss quartz movement, mother-of-pearl
dial set with 137 diamonds (0.52ct), black
numerals in Roman style, black hands,
bracelet with screw-system for length
adjustment, special safety snap buckle.

Limited Edition: 25 pieces





Ref. 65 11-2537-WQDB a

Harmony - 6

18kt white gold watchcase and links set with 1085 diamonds (8.02ct) and 63 diamond squares princess cut (5.67ct), cut sapphire crystal, water resistant (3 ATM), high quality Swiss quartz movement, mother-of-pearl dial (Tahiti) set with 137 diamonds (0.52ct), silver numerals in Roman style, black hands, bracelet with screw-system for length adjustment, special safety snap buckle.

Limited Edition: 25 pieces



Ref. 6512-2537-WQDB a

Harmony - 6

18kt white gold watchcase and links set with 1085 diamonds (8.02ct) and 63 ruby squares princess cut (7.84ct), cut sapphire crystal, water resistant (3 ATM), high quality

Swiss quartz movement, mother-of-pearl dial (Tahiti) set with 137 diamonds (0.52ct), silver numerals in Roman style, black hands, bracelet with screw-system for length adjustment, special safety snap buckle.

Limited Edition: 25 pieces



Ref. 65 13-2537-WQBDB

Harmony - 6

18kt white gold watchcase and links set with 1085 diamonds (8.02ct) and 63 blue sapphire squares princess cut (7.32ct), cut sapphire crystal, water resistant (3 ATM), high quality Swiss quartz movement, mother-of-pearl dial set with 137 diamonds (0.52ct), black numerals in Roman style, black hands, bracelet with screw-system for length adjustment, special safety snap buckle.

Limited Edition: 25 pieces



Ref. 6518-2537-WQDB

Harmony - 6
18kt white gold watchcase and links set with
1085 diamonds (8.02ct) and 63 tsavorite
squares princess cut (5.36ct), cut sapphire
crystal, water resistant (3 ATM), high quality
Swiss quartz movement, mother-of-pearl
dial set with 137 diamonds (0.52ct), black
numerals in Roman style, black hands,
bracelet with screw-system for length
adjustment, special safety snap buckle.

Limited Edition: 25 pieces





Ref. 65 18-2537-WQDB a

Harmony - 6

18kt white gold watchcase and links set with 1085 diamonds (8.02ct) and 63 tsavorite squares princess cut (5.36ct), cut sapphire crystal, water resistant (3 ATM), high quality Swiss quartz movement, mother-of-pearl dial (Tahiti) set with 137 diamonds (0.52ct), silver numerals in Roman style, black hands, bracelet with screw-system for length adjustment, special safety snap buckle.

Limited Edition: 25 pieces

KERN

COLLECTION - SERIES

Tizian



Ref. 65 11-2496-WQDB

Tizian - 1

18kt white gold watchcase with moveable chaton links set with 208 diamonds (4.51ct) and 24 diamond tapers princess cut (3.36ct), round sapphire crystal, water resistant (3 ATM), high quality quartz movement, sterling-silver dial pavé set with 128 diamonds (0.95ct), black hands, satin strap with 18kt gold pin buckle set with 52 diamonds (0.41ct).

Limited Edition: 50 pieces



Ref. 6511-2497-WQBDB

Tizian - 2

18kt white gold watchcase with moveable chaton links set with 204 diamonds (4.48ct), 32 diamond tapers princess cut (4.45ct) and 24 blue sapphire tapers (8.02ct), round sapphire crystal, water resistant (3 ATM), high quality quartz movement, sterling-silver dial pavé set with 128 diamonds (0.95ct), black hands, satin strap with 18kt gold pin buckle set with 52 diamonds (0.41ct).

Limited Edition: 50 pieces





Ref. 65 11-2497-WQDB

Tizian - 2

18kt white gold watchcase with moveable chaton links set with 204 diamonds (4.48ct) and 56 diamond tapers princess cut (7.78ct), round sapphire crystal, water resistant (3 ATM), high quality quartz movement, sterling-silver dial pavé set with 128 diamonds (0.95ct), black hands, satin strap with 18kt gold pin buckle set with 52 diamonds (0.41ct).

Limited Edition: 50 pieces



cover closed

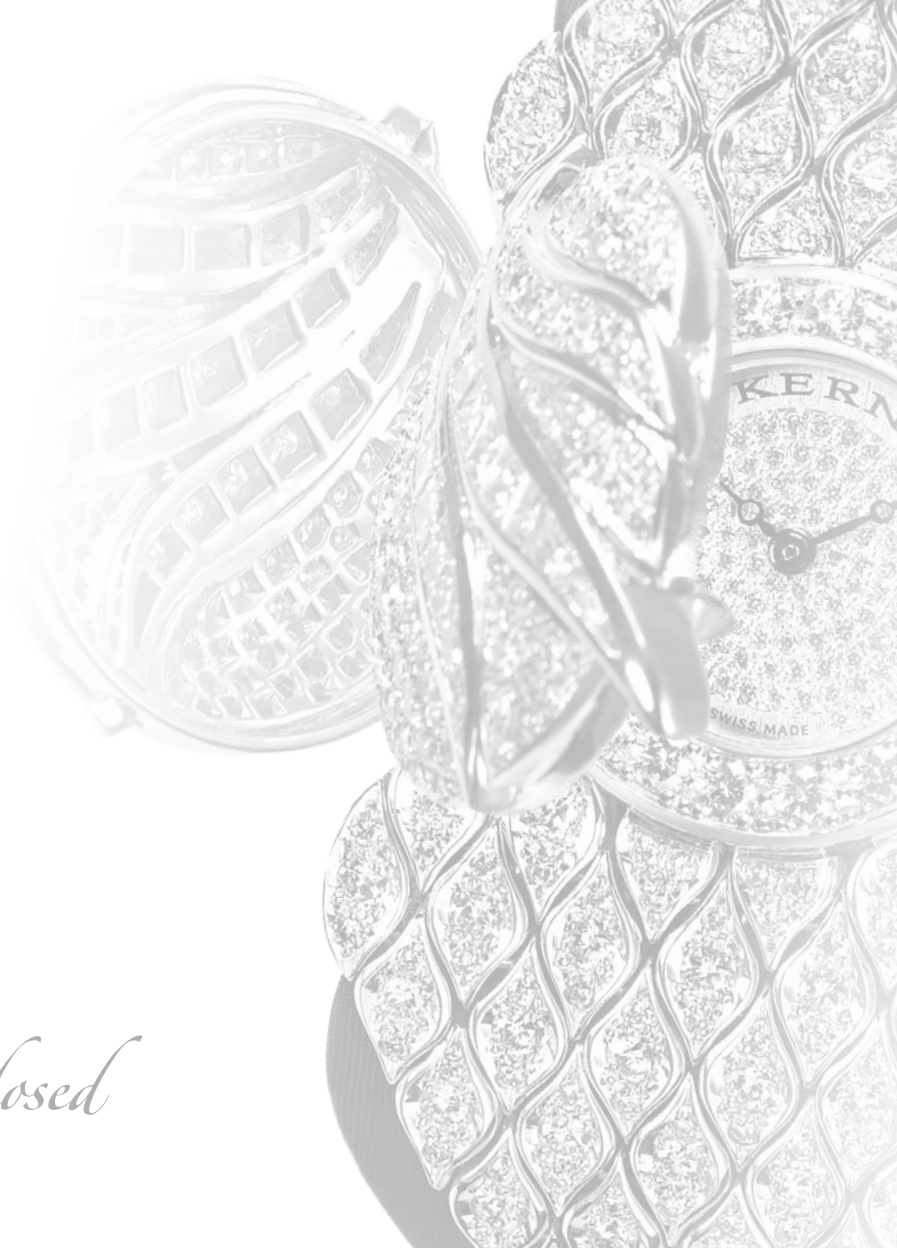



cover open

*cover
system*

Ref. 65 11-2498-WQDB

Tizian - 3

18kt white gold watchcase with moveable chaton links and cover system set with 309 diamonds (7.51ct) and 24 diamond tapers princess cut (2.68ct), round sapphire crystal, water resistant (3 ATM), high quality quartz movement, sterling-silver dial pavé set with 128 diamonds (0.95ct), black hands, satin strap with 18kt gold pin buckle set with 52 diamonds (0.41ct).

Limited Edition: 50 pieces



Ref. 6511-2511-RQ

Tizian - 4

18kt rosé gold watchcase set with 512 diamonds (6.67ct), round sapphire crystal, water resistant (3 ATM), high quality quartz movement, mother-of-pearl dial with numeral appliqué and 3 diamonds as indexes, rosé hands, extra wide satin strap with 4 integrated decoration hemispheres set with 68 diamonds (0.82ct), 18kt gold pin buckle set with 88 diamonds (0.86ct).

Limited Edition: 50 pieces



Ref. 65 11-25 11-RQDB

Tizian - 4

18kt rosé gold watchcase set with 512 diamonds (6.67ct), round sapphire crystal, water resistant (3 ATM), high quality quartz movement, sterling-silver dial pavé set with 128 diamonds (0.95ct), black hands, extra wide satin strap with 4 integrated decoration hemispheres set with 68 diamonds (0.82ct), 18kt gold pin buckle set with 88 diamonds (0.86ct).

Limited Edition: 50 pieces

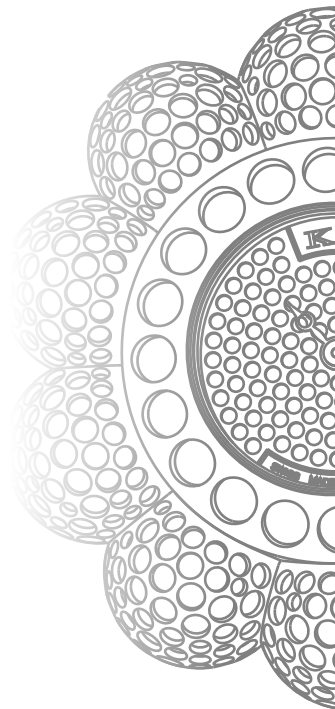

Ref. 6511-2511-WQ

Tizian - 4
18kt white gold watchcase set with 512
diamonds (6.67ct), round sapphire crystal,
water resistant (3 ATM), high quality
quartz movement, mother-of-pearl dial
with numeral appliqué and 3 diamonds as
indexes, silver hands, extra wide satin strap
with 4 integrated decoration hemispheres
set with 68 diamonds (0.82ct), 18kt gold
pin buckle set with 88 diamonds (0.86ct).

Limited Edition: 50 pieces

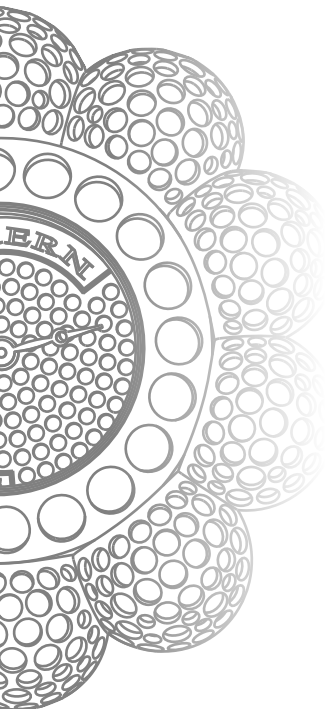

Ref. 65 11-25 11-WQDB

Tizian - 4

18kt white gold watchcase set with 512 diamonds (6.67ct), round sapphire crystal, water resistant (3 ATM), high quality quartz movement, sterling-silver dial pavé set with 128 diamonds (0.95ct), black hands, extra wide satin strap with 4 integrated decoration hemispheres set with 68 diamonds (0.82ct), 18kt gold pin buckle set with 88 diamonds (0.86ct).

Limited Edition: 50 pieces



Ref. 6511-2512-RQDB

Tizian - 6

18kt rosé gold watchcase set with 68 diamonds (4.05ct), round sapphire crystal, water resistant (3 ATM), high quality quartz movement, sterling-silver dial pavé set with 128 diamonds (0.95ct), black hands, extra wide satin strap with 4 integrated decoration hearts set with 68 diamonds (0.65ct), 18kt gold pin buckle set with 88 diamonds (0.86ct).

Limited Edition: 50 pieces



Ref. 65 11-25 12-WQDB

Tizian - 6

18kt white gold watchcase set with 68 diamonds (4.05ct), round sapphire crystal, water resistant (3 ATM), high quality quartz movement, sterling-silver dial pavé set with 128 diamonds (0.95ct), black hands, extra wide satin strap with 4 integrated decoration hearts set with 68 diamonds (0.65ct), 18kt gold pin buckle set with 88 diamonds (0.86ct).

Limited Edition: 50 pieces





Ref. 65 11-25 18-RQDB

Tizian - 7

18kt rosé gold watchcase set with 116 diamonds (2.36ct), round sapphire crystal, water resistant (3 ATM), high quality quartz movement, sterling-silver dial pavé set with 128 diamonds (0.95ct), black hands, silk strap (Moiré style with ornament stitching) with 18kt gold pin buckle set with 45 diamonds (0.37ct).

Limited Edition: 20 pieces



Ref. 6511-2518-WQDB

Tizian - 7

18kt white gold watchcase set with 116 diamonds (2.36ct), round sapphire crystal, water resistant (3 ATM), high quality quartz movement, sterling-silver dial pavé set with 128 diamonds (0.95ct), black hands, silk strap (Moiré style with ornament stitching) with 18kt gold pin buckle set with 45 diamonds (0.37ct).

Limited Edition: 20 pieces





Ref. 65 11-2534-WQDB

Tizian - 7

18kt white gold watchcase and multipart gold bracelet set with 316 diamonds (5.48ct), round sapphire crystal, water resistant (3 ATM), high quality Swiss quartz movement, sterling-silver dial pavé set with 128 diamonds (0.95ct), black hands, bracelet with screw-system for length adjustment, safety snap buckle.

Limited Edition: 20 pieces

KERN

COLLECTION - SERIES

GRAND DAME



Ref. 65 11-2476-WQDB

18kt white gold watchcase set with 202 diamonds (9.98ct), gold crown set with blue sapphire-cabochon, movable chaton links in various length, curved sapphire crystal, water resistant (3 ATM), high quality Swiss quartz movement, mother-of-pearl dial set with 68 white diamonds (0.35ct), silver appliqué numerals in Roman style, silver hands, natural silk strap with 18kt gold pin buckle set with 86 white diamonds (0.53ct).

Limited Edition: 20 pieces



Ref. 6511-2476-RQDB b

18kt rosé gold watchcase set with 202 diamonds (9.98ct), gold crown set with sapphire-cabochon, movable chaton links in various length, curved sapphire crystal, water resistant (3 ATM), high quality Swiss quartz movement, sterling silver dial pavé set with 319 white diamonds (1.35ct), black hands, satin strap with 18kt gold pin buckle set with 86 white diamonds (0.53ct).

Limited Edition: 20 pieces



Ref. 65 11-2476-WQDB b

18kt white gold watchcase set with 202 diamonds (9.98ct), gold crown set with blue sapphire-cabochon, movable chaton links in various length, curved sapphire crystal, water resistant (3 ATM), high quality Swiss quartz movement, sterling silver dial pavé set with 319 white diamonds (1.35ct), black hands, natural silk strap with 18kt gold pin buckle set with 86 white diamonds (0.53ct).

Limited Edition: 20 pieces

KERN

COLLECTION - SERIES

VISION

VISION



Ref. 9500-2430-A

VISION - 1

Stainless steel watchcase with brushed bezel, sapphire crystal on frontside (curved) and caseback, water resistant (5 ATM), automatic winding movement with lunar phase indication and date, sterling-silver guilloché dial (hand guilloché on rose-engine) with oval styled Roman numerals, blued hands, alligator leather strap with butterfly buckle.

Limited Edition: 100 pieces



Ref. 9500-2430-A a

VISION - 1

Stainless steel watchcase with brushed bezel, sapphire crystal on frontside (curved) and caseback, water resistant (5 ATM), automatic winding movement with lunar phase indication and date, sterling-silver guilloché dial (hand guilloché on rose-engine, zones blackened by galvanic) with oval styled Roman numerals, blued hands, alligator leather strap with butterfly buckle.

Limited Edition: 100 pieces



Ref. 9500-2433-A

VISION - 2

Stainless steel watchcase with brushed bezel, sapphire crystal on frontside (curved) and caseback, water resistant (5 ATM), automatic winding movement with special positioned hour-, second indication and date, sterling-silver guilloché dial (hand guilloché on rose-engine) with curvate structure, blued hands, alligator leather strap with butterfly buckle.

Limited Edition: 100 pieces



Ref. 9500-2436-A

VISION - 3

Stainless steel watchcase with brushed bezel, sapphire crystal on frontside (curved) and caseback, water resistant (5 ATM), automatic winding movement with lunar phase indication and date, sterling-silver guilloché dial (hand guilloché on rose-engine) with traditional Roman numerals, blued hands, alligator leather strap with butterfly buckle.

Limited Edition: 100 pieces





Ref. 9500-2448-A a

VISION - 4.2

Stainless steel watchcase with brushed bezel, sapphire crystal on frontside (curved) and caseback, water resistant (5 ATM), automatic winding movement with lunar phase indication and date, sterling-silver guilloché dial (hand guilloché on rose-engine) with mother-of-pearl inlay, modern styled numerals, blued hands, alligator leather strap with butterfly buckle.

Limited Edition: 100 pieces



Ref. 9511-2431-A

VISION - 1

Stainless steel watchcase set with 60 diamonds (1.35ct), sapphire crystal on frontside (curved) and caseback, water resistant (5 ATM), automatic winding movement with lunar phase indication and date, sterling-silver guilloché dial (hand guilloché on rose-engine) with oval styled Roman numerals, blued hands, alligator leather strap with butterfly buckle.

Limited Edition: 50 pieces



traditional blued hands



date indication



hand guilloché dial



lunar phase indication



Swiss Made



Ref. 95 11-2432-A

VISION - 1

Stainless steel watchcase set with 192 diamonds (1.42ct), sapphire crystal on frontside (curved) and caseback, water resistant (5 ATM), automatic winding movement with lunar phase indication and date, sterling-silver guilloché dial (hand guilloché on rose-engine) with oval styled Roman numerals, blued hands, alligator leather strap with butterfly buckle.

Limited Edition: 50 pieces



Ref. 9511-2434-A

VISION - 2

Stainless steel watchcase set with 60 diamonds (1.35ct), sapphire crystal on frontside (curved) and caseback, water resistant (5 ATM), automatic winding movement with special positioned hour, second indication and date, sterling-silver guilloché dial (hand guilloché on rose-engine) with curvate structure, blued hands, alligator leather strap with butterfly buckle.

Limited Edition: 50 pieces



date indication



second indication



hand guilloché dial



hour indication

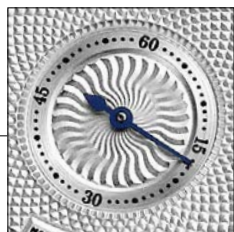

Swiss Made



Ref. 95 11-2435-A

VISION - 2

Stainless steel watchcase set with 192 diamonds (1.42ct), sapphire crystal on frontside (curved) and caseback, water resistant (5 ATM), automatic winding movement with special positioned hour-, second indication and date, sterling-silver guilloché dial (hand guilloché on rose-engine) with curvate structure, blued hands, alligator leather strap with butterfly buckle.

Limited Edition: 50 pieces



Ref. 9511-2437-A

VISION - 3

Stainless steel watchcase set with 60 diamonds (1.35ct), sapphire crystal on frontside (curved) and caseback, water resistant (5 ATM), automatic winding movement with lunar phase indication and date, sterling-silver guilloché dial (hand guilloché on rose-engine) with traditional Roman numerals, blued hands, alligator leather strap with butterfly buckle.

Limited Edition: 50 pieces



traditional blued hands

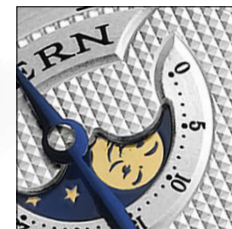

date indication



hand guilloché dial



lunar phase indication



Swiss Made



Ref. 9511-2438-A

VISION - 3

Stainless steel watchcase set with 192 diamonds (1.42ct), sapphire crystal on frontside (curved) and caseback, water resistant (5 ATM), automatic winding movement with lunar phase indication and date, sterling-silver guilloché dial (hand guilloché on rose-engine) with traditional Roman numerals, blue hands, alligator leather strap with butterfly buckle.

Limited Edition: 50 pieces



Ref. 9511-2446-A a

VISION - 4.1

Stainless steel watchcase set with 60 diamonds (1.35ct), sapphire crystal on frontside (curved) and caseback, water resistant (5 ATM), automatic winding movement with lunar phase indication and date, sterling-silver guilloché dial (hand guilloché on rose-engine) with mother-of-pearl inlay, modern Roman numerals, blued hands, alligator leather strap with butterfly buckle.

Limited Edition: 50 pieces



Ref. 95 11-2447-A b

VISION - 4.1

Stainless steel watchcase set with 192 diamonds (1.42ct), sapphire crystal on frontside (curved) and caseback, water resistant (5 ATM), automatic winding movement with lunar phase indication and date, sterling-silver guilloché dial (hand guilloché on rose-engine) with mother-of-pearl (Tahiti) inlay, modern Roman numerals, blued hands, alligator leather strap with butterfly buckle.

Limited Edition: 50 pieces



Ref. 9511-2449-A a

VISION - 4.2

Stainless steel watchcase set with 60 diamonds (1.35ct), sapphire crystal on frontside (curved) and caseback, water resistant (5 ATM), automatic winding movement with lunar phase indication and date, sterling-silver guilloché dial (hand guilloché on rose-engine) with mother-of-pearl inlay, modern styled numerals, blued hands, alligator leather strap with butterfly buckle.

Limited Edition: 50 pieces





Ref. 95 11-2450-A a

VISION - 4.2

Stainless steel watchcase set with 192 diamonds (1.42ct), sapphire crystal on frontside (curved) and caseback, water resistant (5 ATM), automatic winding movement with lunar phase indication and date, sterling-silver guilloché dial (hand guilloché on rose-engine) with mother-of-pearl inlay, modern styled numerals, blued hands, alligator leather strap with butterfly buckle.

Limited Edition: 50 pieces



Stainless steel butterfly buckle with hand-sewn full grain alligator strap.



Ref. 95 11-2492-A

VISION - 5.4

Stainless steel watchcase set with 72 diamonds (1.73ct), sapphire crystal on frontside (curved) and caseback, water resistant (5 ATM), high quality automatic winding movement, sterling-silver dial set with 259 diamonds (1.65ct) and 4 engraved numerals, blued hands, alligator leather strap with butterfly buckle.

Limited Edition: 50 pieces



Ref. 9511-2457-A

VISION - 5

Stainless steel watchcase set with 72 diamonds (1.71ct), sapphire crystal on frontside (curved) and caseback, water resistant (5 ATM), high quality automatic winding movement, mother-of-pearl dial with modern styled numerals set with 115 diamonds (0.52ct), blued hands, ocean stingray strap (galuchat) with butterfly buckle.

Limited Edition: 50 pieces



Ref. 9511-2457-A a

VISION - 5

Stainless steel watchcase set with 72 diamonds (1.71ct), sapphire crystal on frontside (curved) and caseback, water resistant (5 ATM), high quality automatic winding movement, mother-of-pearl dial (Tahiti) with modern styled numerals set with 115 diamonds (0.52ct), blued hands, ocean stingray strap (galuchat) with butterfly buckle.

Limited Edition: 50 pieces

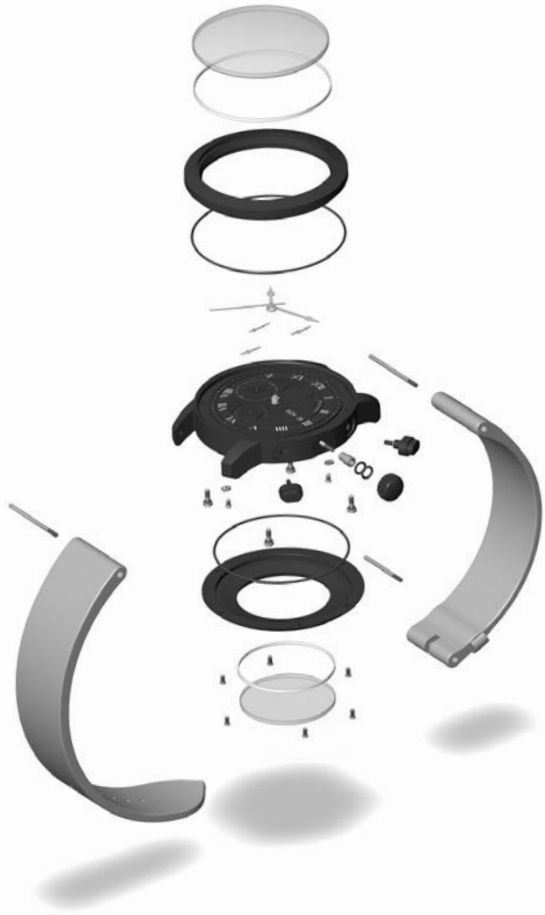

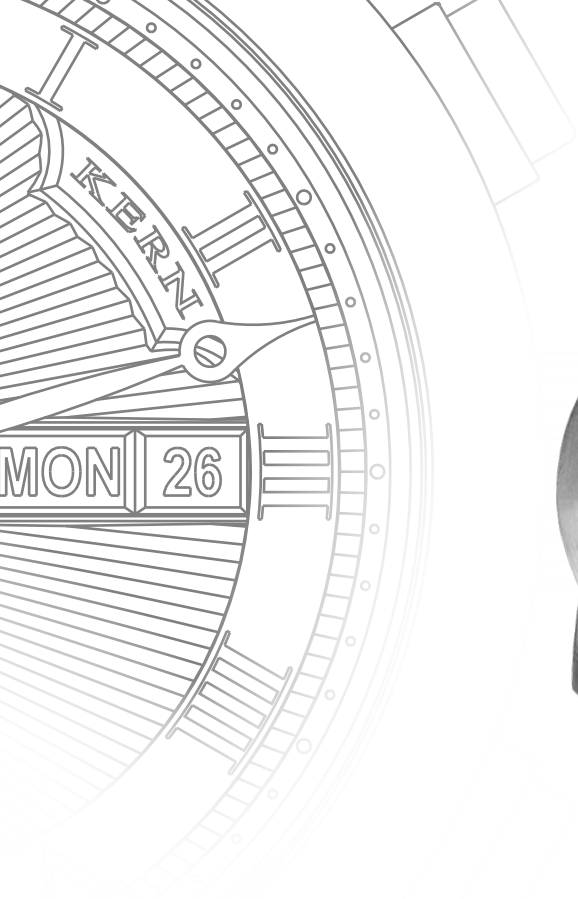

Ref. 9400-25 15-A a

VISION - 7.1

Stainless steel watchcase with brushed surface, covered with high tech ceramic, sapphire crystal on frontside (curved) and caseback, water resistant (5 ATM), automatic winding movement with chronograph functions and day / date indication, galvanic black sterling-silver guilloché dial (hand guilloché on rose-engine) with white Roman numerals, white hands, alligator leather strap with black butterfly buckle.

Limited Edition: 100 pieces

Ref. 9511-2516-A a

VISION - 7

Stainless steel watchcase set with 60 diamonds (1.30ct), sapphire crystal on frontside (curved) and caseback, water resistant (5 ATM), automatic winding movement with chronograph functions and day / date indication, galvanic black sterling-silver guilloché dial (hand guilloché on rose-engine) with white Roman numerals, white hands, ocean stingray strap (galuchat) with butterfly buckle.

Limited Edition: 100 pieces





Ref. 9511-2516-A

VISION - 7

Stainless steel watchcase set with 60 diamonds (1.30ct), sapphire crystal on frontside (curved) and caseback, water resistant (5 ATM), automatic winding movement with chronograph functions and day / date indication, sterling-silver guilloché dial (hand guilloché on rose-engine) with black Roman numerals, black hands, ocean stingray strap (galuchat) with butterfly buckle.

Limited Edition: 100 pieces

KERN

COLLECTION - SERIES

La Princesse



Ref. 65 11-2471-WQDB

18kt white gold multi-part watchcase in oval shape set with 175 diamonds (4.83ct), sapphire crystal with diamond facet cut, water resistant (3 ATM), high quality quartz movement with corrector on the caseback, mother-of-pearl dial with 128 diamonds (0.80ct), black Roman numerals, black hands, silk strap (Moiré style with ornament stitching) with 18kt gold pin buckle set with 28 diamonds (0.21ct).

Limited Edition: 25 pieces



Ref. 6511-2472-WQDB

18kt white gold multi-part watchcase in oval shape set with 181 diamonds (4.37ct) and 80 diamond squares princess cut (8.30ct), sapphire crystal with diamond facet cut, water resistant (3 ATM), high quality quartz movement with corrector on the caseback, mother-of-pearl dial with 128 diamonds (0.80ct), black Roman numerals, black hands, silk strap (Moiré style with ornament stitching) with 18kt gold pin buckle set with 29 diamonds (0.21ct).

Limited Edition: 25 pieces





Ref. 65 11-2472-WQDB a

18kt white gold multi-part watchcase in oval shape set with 181 diamonds (4.37ct) and 80 diamond squares princess cut (8.30ct), sapphire crystal with diamond facet cut, water resistant (3 ATM), high quality quartz movement with corrector on the caseback, mother-of-pearl dial (Tahiti) with 128 diamonds (0.80ct), silver Roman numerals, silver hands, silk strap (Moiré style with ornament stitching) with 18kt gold pin buckle set with 29 diamonds (0.21ct).

Limited Edition: 25 pieces



Ref. 6511-2490-WQDB

18kt white gold multi-part watchcase in oval shape set with 230 diamonds (7.28ct), movable chaton links in various length, sapphire crystal with diamond facet cut, water resistant (3 ATM), high quality quartz movement with corrector on the caseback, mother-of-pearl dial with 128 diamonds (0.80ct), black Roman numerals, black hands, silk strap (Moiré style) with 18kt gold pin buckle set with 26 diamonds (0.20ct).

Limited Edition: 25 pieces





Ref. 65 11-2490-WQDB a

18kt white gold multi-part watchcase in oval shape set with 230 diamonds (7.28ct), movable chaton links in various length, sapphire crystal with diamond facet cut, water resistant (3 ATM), high quality quartz movement with corrector on the caseback, mother-of-pearl dial (Tahiti) with 128 diamonds (0.80ct), silver Roman numerals, silver hands, silk strap (Moiré style) with 18kt gold pin buckle set with 26 diamonds (0.20ct).

Limited Edition: 25 pieces

KERN

COLLECTION - SERIES

LA FEMME



Ref. 65 11-2473-WQDB

18kt white gold watchcase set with 269 white diamonds (5.35ct), round sapphire crystal, water resistant (3 ATM), high quality Swiss quartz movement, sterling-silver dial pavé set with 128 diamonds (0.95ct), black hands, silk strap (Moiré style) with 18kt gold pin buckle set with 28 diamonds (0.21ct).

Limited Edition: 20 pieces



Ref. 6512-2465-WQDB

18kt white gold watchcase set with 306 ruby (4.71ct) in soft colour gradient and 48 white diamonds (0.50ct), round sapphire crystal, water resistant (3 ATM), high quality Swiss quartz movement, sterling-silver dial pavé set with 128 diamonds (0.95ct), black hands, silk strap with 18kt gold pin buckle set with 28 diamonds (0.21ct).

Limited Edition: 20 pieces



Ref. 65 13-2465-WQBDB

18kt white gold watchcase set with 306 blue sapphire (4.71ct) in soft colour gradient and 48 white diamonds (0.50ct), round sapphire crystal, water resistant (3 ATM), high quality Swiss quartz movement, sterling-silver dial pavé set with 128 diamonds (0.95ct), black hands, silk strap with 18kt gold pin buckle set with 28 diamonds (0.21ct).

Limited Edition: 20 pieces



Ref. 6513-2473-WQBDB

18kt white gold watchcase set with 249 white diamonds (2.53ct) and 20 blue sapphire (1.88ct), round sapphire crystal, water resistant (3 ATM), high quality Swiss quartz movement, sterling-silver dial pavé set with 128 diamonds (0.95ct), black hands, silk strap with 18kt gold pin buckle set with 28 diamonds (0.21ct).

Limited Edition: 20 pieces





Ref. 65 12-2473-WQDB

18kt white gold watchcase set with 249 white diamonds (2.53ct) and 20 ruby (1.88ct), round sapphire crystal, water resistant (3 ATM), high quality Swiss quartz movement, sterling-silver dial pavé set with 128 diamonds (0.95ct), black hands, silk strap with 18kt gold pin buckle set with 28 diamonds (0.21ct).

Limited Edition: 20 pieces



Ref. 6518-2465-GQ

18kt yellow gold watchcase set with 306 tsavorite (4.78ct) in soft colour gradient and 48 white diamonds (0.50ct), round sapphire crystal, water resistant (3 ATM), high quality Swiss quartz movement, mother-of-pearl dial with numeral appliqué and 3 diamonds as indexes, yellow hands, silk strap (Moiré style) with 18kt gold pin buckle set with 28 diamonds (0.21ct).

Limited Edition: 20 pieces





Ref. 6521-2478-WQDB

18kt white gold watchcase set with 249 white diamonds (2.53ct) and 24 diamond tapers (4.68ct), round sapphire crystal, water resistant (3 ATM), high quality Swiss quartz movement, sterling-silver dial pavé set with 128 diamonds (0.95ct), black hands, silk strap (Moiré style) with 18kt gold pin buckle set with 28 diamonds (0.21ct).

Limited Edition: 20 pieces



Ref. 6523-2477-WQP

18kt white gold watchcase set with 286 pink sapphire (4.30ct) in soft colour gradient, 48 white diamonds (0.51ct) and 24 pink sapphire tapers (4.63ct), round sapphire crystal, water resistant (3 ATM), high quality Swiss quartz movement, mother-of-pearl dial with numeral appliqué and 3 diamonds as indexes, silver hands, silk strap with 18kt gold pin buckle set with 28 diamonds (0.21ct).

Limited Edition: 20 pieces

Ref. 6523-2477-GQG

18kt yellow gold watchcase set with 286 yellow sapphire (4.35ct) in soft colour gradient, 48 white diamonds (0.51ct) and 24 yellow sapphire tapers (4.61ct), round sapphire crystal, water resistant (3 ATM), high quality Swiss quartz movement, mother-of-pearl dial with numeral appliqué and 3 diamonds as indexes, yellow hands, silk strap (Moiré style) with 18kt gold pin buckle set with 28 diamonds (0.21ct).

Limited Edition: 20 pieces



Ref. 6522-2477-WQDB

18kt white gold watchcase set with 286 ruby (4.30ct) in soft colour gradient, 48 white diamonds (0.51ct) and 24 ruby tapers (4.63ct), round sapphire crystal, water resistant (3 ATM), high quality Swiss quartz movement, sterling-silver dial pavé set with 128 diamonds (0.95ct), black hands, silk strap with 18kt gold pin buckle set with 28 diamonds (0.21ct).

Limited Edition: 20 pieces



Ref. 6525-2477-WQ

18kt white gold watchcase set with 286 aquamarine (4.30ct) in soft colour gradient, 48 white diamonds (0.51ct) and 24 aquamarine tapers (4.63ct), round sapphire crystal, water resistant (3 ATM), high quality Swiss quartz movement, mother-of-pearl dial with numeral appliqué and 3 diamonds as indexes, silver hands, silk strap with 18kt gold pin buckle set with 28 diamonds (0.21ct).

Limited Edition: 20 pieces



Ref. 6528-2477-GQ

18kt yellow gold watchcase set with 286 tsavorite (4.30ct) in soft colour gradient, 48 white diamonds (0.51ct) and 24 tsavorite tapers (4.61ct), round sapphire crystal, water resistant (3 ATM), high quality Swiss quartz movement, mother-of-pearl dial with numeral appliqué and 3 diamonds as indexes, yellow hands, silk strap (Moiré style) with 18kt gold pin buckle set with 28 diamonds (0.21ct).

Limited Edition: 20 pieces

KERN

COLLECTION - SERIES

Les Briolettes



Ref. 65 13-2461-WQWDB a

18kt white gold multi-part watchcase in oval shape, sapphire crystal with diamond facet cut, water resistant (3 ATM), high quality quartz movement with corrector on the caseback, movable 36 white sapphire briolette (approx. 31.00ct), mother-of-pearl dial (Tahiti) with 128 diamonds (0.80ct), silver Roman numerals, silver hands, silk strap with 18kt gold pin buckle set with 28 diamonds (0.21ct).

Limited Edition: 20 pieces



Ref. 6551-2461-WQDB

18kt white gold multi-part watchcase in oval shape, sapphire crystal with diamond facet cut, water resistant (3 ATM), high quality quartz movement with corrector on the caseback, movable 36 natural pearl drops, mother-of-pearl dial with 128 diamonds (0.80ct), black Roman numerals, black hands, silk strap with 18kt gold pin buckle set with 28 diamonds (0.21ct).

Limited Edition: 20 pieces





Ref. 6551-2461-WQTDB a

18kt white gold multi-part watchcase in oval shape, sapphire crystal with diamond facet cut, water resistant (3 ATM), high quality quartz movement with corrector on the caseback, movable 36 natural pearl drops (Tahiti), mother-of-pearl dial (Tahiti) with 128 diamonds (0.80ct), silver Roman numerals, silver hands, silk strap with 18kt gold pin buckle set with 28 diamonds (0.21ct).

Limited Edition: 20 pieces

KERN

COLLECTION - SERIES

FALCON LINE

The tradition, love and passion to falcons and the falcon hunting sport in Arab countries was the inspiration to develop this watch edition and to register as a patent. Authentic falcon feathers have to be prepared through a special and work-intensive procedure before they are used in our jewellery and watches. Each merchandise is a unique piece as no feather is identical to another.





Ref. 4399-2219-W

18kt white gold chain with 18kt white gold pendant set with 68 diamonds (1.48ct), 24 tsavorite tapers (2.59ct), 8 ruby tapers (1.49ct), sapphire crystal, water resistant (1 ATM), screwed backside with engraved falcon, authentic falcon feather inside.

Limited Edition: 50 pieces



Ref. 6311-2224-WH

“Classic” Edition

18kt white gold watchcase set with 56 diamonds (1.63ct), sapphire crystal, water resistant (5 ATM), manual winding movement, authentic falcon feather as a watch face, silver hands, alligator leather strap with 18kt gold pin buckle.

Ref. 6331-2252-WQ

“Classic” Edition

18kt white gold watchcase set with 60 diamonds tapers (2.98ct), sapphire crystal, water resistant (5 ATM), Swiss quartz movement, authentic falcon feather as a watch face, silver hands, alligator leather strap with 18kt gold pin buckle.



Ref. 6329-2260-WQ

“U.A.E.” Edition

18kt white gold watchcase set with 15 diamond tapers, 15 black diamond tapers, 15 ruby tapers, 15 tsavorite tapers, sapphire crystal, water resistant (5 ATM), Swiss quartz movements, authentic falcon feather as a watch face, silver hands, alligator leather strap with 18kt gold pin buckle.

KERN

SINCE 1974

EXCLUSIVE SWISS TIMEPIECES

HEAD- & MARKETING OFFICE

KERN International KG

Im Steinig 14

75210 Kelters

GERMANY

www.@KERN-watches.com

info@KERN-watches.com

GENEVÉ

www.KERN-watches.ch

info@KERN-watches.ch

All models are registered and protected by law.

Photographs and technical descriptions are not contractually binding.

KERN reserves the right to change or modify presented models at any time.

printed in Switzerland #069-002

